

Metal Barrel-M18 Short Version

General Data

- Metal housing
- Threaded barrel M18x1
- DC 2-wire
- Function display LED
- Degree of protection IP67
- Flush/non flush mounting



Technical Data

Type	Rated operating distance S_n	Mounting	Output function	Output type	Voltage-range U_g	Rated current	Switching frequency	Ambient temperature	Connection	Mechanical Drawing
<i>Fi5-M18S-OD6L</i>	5 mm	flush	NO	DC	10...30VDC	≤100mA	500Hz	-25...70°C	2m cable	M18_11
<i>Fi5-M18S-CD6L</i>	5 mm	flush	NC	DC	10...30VDC	≤100mA	500Hz	-25...70°C	2m cable	M18_11
<i>Ni8-M18S-OD6L</i>	8 mm	non flush	NO	DC	10...30VDC	≤100mA	300Hz	-25...70°C	2m cable	M18_21
<i>Ni8-M18S-CD6L</i>	8 mm	non flush	NC	DC	10...30VDC	≤100mA	300Hz	-25...70°C	2m cable	M18_21
<i>Fi5-M18S-OD6L-Q12</i>	5 mm	flush	NO	DC	10...30VDC	≤100mA	500Hz	-25...70°C	M12 connector	M18_31
<i>Fi5-M18S-CD6L-Q12</i>	5 mm	flush	NC	DC	10...30VDC	≤100mA	500Hz	-25...70°C	M12 connector	M18_31
<i>Ni8-M18S-OD6L-Q12</i>	8 mm	non flush	NO	DC	10...30VDC	≤100mA	300Hz	-25...70°C	M12 connector	M18_41
<i>Ni8-M18S-CD6L-Q12</i>	8 mm	non flush	NC	DC	10...30VDC	≤100mA	300Hz	-25...70°C	M12 connector	M18_41

Connection Diagram

Bu = blue; Bn = brown; Bk = black; Wh = white; (1-4) = Connector pin M12

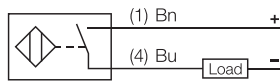

DC-2 wire NO

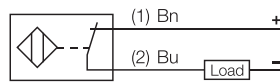

DC-2 wire NC

Mechanical Drawing

Drawing M18_11

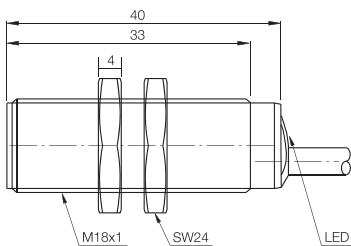

Drawing M18_21

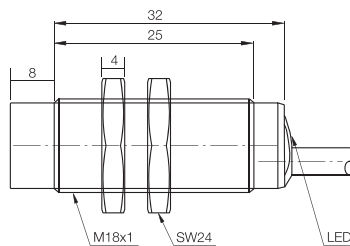

Drawing M18_31

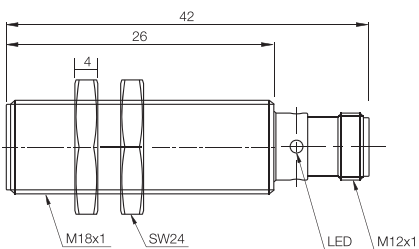

Drawing M18_41

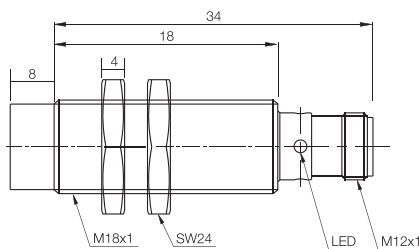

Approvals
Certificates



Metal Barrel-M18

General Data

- Metal housing
- Threaded barrel M18x1
- DC 2-wire
- Function display LED
- Degree of protection IP67
- Standard size
- Flush/non flush mounting



Technical Data

Type	Rated operating distance S_n	Mounting	Output function	Output type	Voltage-range U_b	Rated current	Switching frequency	Ambient temperature	Connection	Mechanical Drawing
<i>Fi5-M18-OD6L</i>	5 mm	flush	NO	DC	10...30VDC	≤100mA	500Hz	-25...70°C	2m cable	M18_12
<i>Fi5-M18-CD6L</i>	5 mm	flush	NC	DC	10...30VDC	≤100mA	500Hz	-25...70°C	2m cable	M18_12
<i>Ni8-M18-OD6L</i>	8 mm	non flush	NO	DC	10...30VDC	≤100mA	300Hz	-25...70°C	2m cable	M18_22
<i>Ni8-M18-CD6L</i>	8 mm	non flush	NC	DC	10...30VDC	≤100mA	300Hz	-25...70°C	2m cable	M18_22
<i>Fi5-M18-OD6L-Q12</i>	5 mm	flush	NO	DC	10...30VDC	≤100mA	500Hz	-25...70°C	M12 connector	M18_32
<i>Fi5-M18-CD6L-Q12</i>	5 mm	flush	NC	DC	10...30VDC	≤100mA	500Hz	-25...70°C	M12 connector	M18_32
<i>Ni8-M18-OD6L-Q12</i>	8 mm	non flush	NO	DC	10...30VDC	≤100mA	300Hz	-25...70°C	M12 connector	M18_42
<i>Ni8-M18-CD6L-Q12</i>	8 mm	non flush	NC	DC	10...30VDC	≤100mA	300Hz	-25...70°C	M12 connector	M18_42

Connection Diagram

Bu = blue; Bn = brown; Bk = black; Wh = white; (1-4) = Connector pin M12

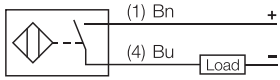

DC-2 wire NO

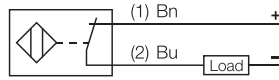

DC-2 wire NC

Mechanical Drawing

Drawing M18_12

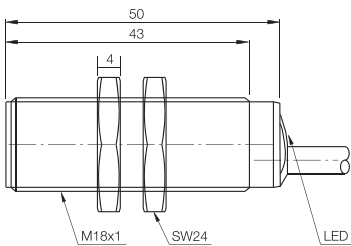

Drawing M18_22

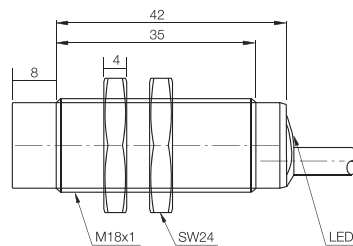

Drawing M18_32

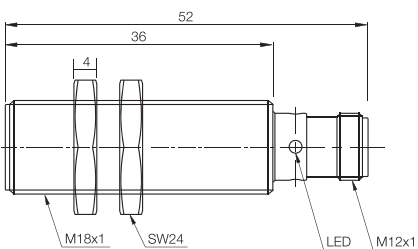

Drawing M18_42

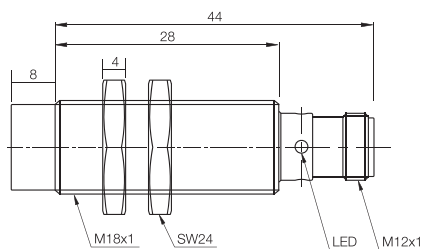

Approvals
Certificates



Metal Barrel-M18 Short Version

General Data

- Metal housing
- Threaded barrel M18x1
- DC 3-wire
- Function display LED
- Degree of protection IP67
- Flush/non flush mounting



Technical Data

Type	Rated operating distance S_n	Mounting	Output function	Output type	Voltage-range U_b	Rated current	Switching frequency	Ambient temperature	Connection	Mechanical Drawing
<i>Fi5-M18S-OP6L</i>	5 mm	flush	NO	PNP	10...30VDC	≤200mA	1000Hz	-25...70°C	2m cable	M18_11
<i>Fi5-M18S-ON6L</i>	5 mm	flush	NO	NPN	10...30VDC	≤200mA	1000Hz	-25...70°C	2m cable	M18_11
<i>Fi5-M18S-CP6L</i>	5 mm	flush	NC	PNP	10...30VDC	≤200mA	1000Hz	-25...70°C	2m cable	M18_11
<i>Fi5-M18S-CN6L</i>	5 mm	flush	NC	NPN	10...30VDC	≤200mA	1000Hz	-25...70°C	2m cable	M18_11
<i>Ni8-M18S-OP6L</i>	8 mm	non flush	NO	PNP	10...30VDC	≤200mA	800Hz	-25...70°C	2m cable	M18_21
<i>Ni8-M18S-ON6L</i>	8 mm	non flush	NO	NPN	10...30VDC	≤200mA	800Hz	-25...70°C	2m cable	M18_21
<i>Ni8-M18S-CP6L</i>	8 mm	non flush	NC	PNP	10...30VDC	≤200mA	800Hz	-25...70°C	2m cable	M18_21
<i>Ni8-M18S-CN6L</i>	8 mm	non flush	NC	NPN	10...30VDC	≤200mA	800Hz	-25...70°C	2m cable	M18_21
<i>Fi5-M18S-OP6L-Q12</i>	5 mm	flush	NO	PNP	10...30VDC	≤200mA	1000Hz	-25...70°C	M12 connector	M18_31
<i>Fi5-M18S-ON6L-Q12</i>	5 mm	flush	NO	NPN	10...30VDC	≤200mA	1000Hz	-25...70°C	M12 connector	M18_31
<i>Fi5-M18S-CP6L-Q12</i>	5 mm	flush	NC	PNP	10...30VDC	≤200mA	1000Hz	-25...70°C	M12 connector	M18_31
<i>Fi5-M18S-CN6L-Q12</i>	5 mm	flush	NC	NPN	10...30VDC	≤200mA	1000Hz	-25...70°C	M12 connector	M18_31
<i>Ni8-M18S-OP6L-Q12</i>	8 mm	non flush	NO	PNP	10...30VDC	≤200mA	800Hz	-25...70°C	M12 connector	M18_41
<i>Ni8-M18S-ON6L-Q12</i>	8 mm	non flush	NO	NPN	10...30VDC	≤200mA	800Hz	-25...70°C	M12 connector	M18_41
<i>Ni8-M18S-CP6L-Q12</i>	8 mm	non flush	NC	PNP	10...30VDC	≤200mA	800Hz	-25...70°C	M12 connector	M18_41
<i>Ni8-M18S-CN6L-Q12</i>	8 mm	non flush	NC	NPN	10...30VDC	≤200mA	800Hz	-25...70°C	M12 connector	M18_41

Connection Diagram

Bu = blue; Bn = brown; Bk = black; Wh = white; (1-4) = Connector pin M12

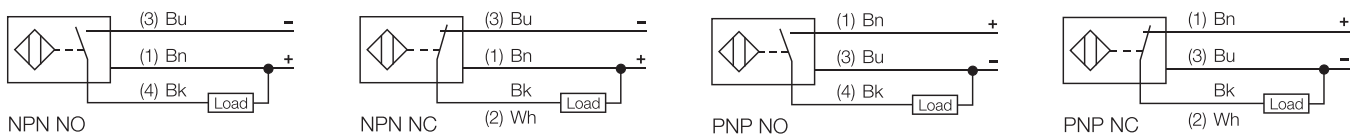

Mechanical Drawing

Drawing M18_11

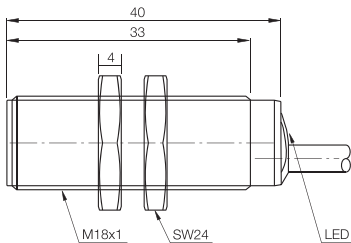

Drawing M18_21

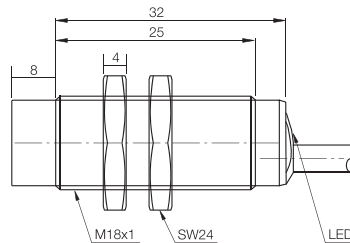

Drawing M18_31

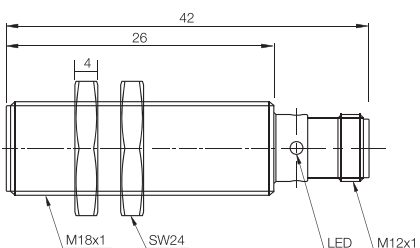

Drawing M18_41

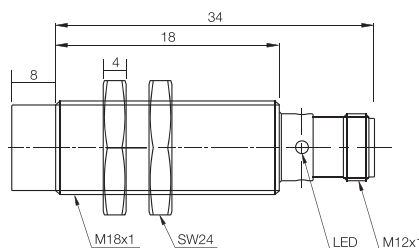

Approvals
Certificates



Metal Barrel-M18

General Data

- Metal housing
- Threaded barrel M18x1
- DC 3-wire
- Function display LED
- Degree of protection IP67
- Standard size
- Flush/non flush mounting



Technical Data

Type	Rated operating distance S_n	Mounting	Output function	Output type	Voltage-range U_b	Rated current	Switching frequency	Ambient temperature	Connection	Mechanical Drawing
Fi5-M18-OP6L	5 mm	flush	NO	PNP	10...30VDC	≤200mA	1000Hz	-25...70°C	2m cable	M18_12
Fi5-M18-ON6L	5 mm	flush	NO	NPN	10...30VDC	≤200mA	1000Hz	-25...70°C	2m cable	M18_12
Fi5-M18-CP6L	5 mm	flush	NC	PNP	10...30VDC	≤200mA	1000Hz	-25...70°C	2m cable	M18_12
Fi5-M18-CN6L	5 mm	flush	NC	NPN	10...30VDC	≤200mA	1000Hz	-25...70°C	2m cable	M18_12
Ni8-M18-OP6L	8 mm	non flush	NO	PNP	10...30VDC	≤200mA	800Hz	-25...70°C	2m cable	M18_22
Ni8-M18-ON6L	8 mm	non flush	NO	NPN	10...30VDC	≤200mA	800Hz	-25...70°C	2m cable	M18_22
Ni8-M18-CP6L	8 mm	non flush	NC	PNP	10...30VDC	≤200mA	800Hz	-25...70°C	2m cable	M18_22
Ni8-M18-CN6L	8 mm	non flush	NC	NPN	10...30VDC	≤200mA	800Hz	-25...70°C	2m cable	M18_22
Fi5-M18-OP6L-Q12	5 mm	flush	NO	PNP	10...30VDC	≤200mA	1000Hz	-25...70°C	M12 connector	M18_32
Fi5-M18-ON6L-Q12	5 mm	flush	NO	NPN	10...30VDC	≤200mA	1000Hz	-25...70°C	M12 connector	M18_32
Fi5-M18-CP6L-Q12	5 mm	flush	NC	PNP	10...30VDC	≤200mA	1000Hz	-25...70°C	M12 connector	M18_32
Fi5-M18-CN6L-Q12	5 mm	flush	NC	NPN	10...30VDC	≤200mA	1000Hz	-25...70°C	M12 connector	M18_32
Ni8-M18-OP6L-Q12	8 mm	non flush	NO	PNP	10...30VDC	≤200mA	800Hz	-25...70°C	M12 connector	M18_42
Ni8-M18-ON6L-Q12	8 mm	non flush	NO	NPN	10...30VDC	≤200mA	800Hz	-25...70°C	M12 connector	M18_42
Ni8-M18-CP6L-Q12	8 mm	non flush	NC	PNP	10...30VDC	≤200mA	800Hz	-25...70°C	M12 connector	M18_42
Ni8-M18-CN6L-Q12	8 mm	non flush	NC	NPN	10...30VDC	≤200mA	800Hz	-25...70°C	M12 connector	M18_42

Connection Diagram

Bu = blue; Bn = brown; Bk = black; Wh = white; (1-4) = Connector pin M12

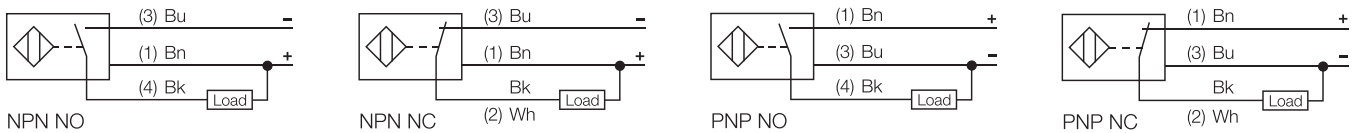

Mechanical Drawing

Drawing M18_12

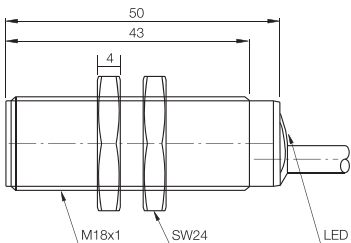

Drawing M18_22

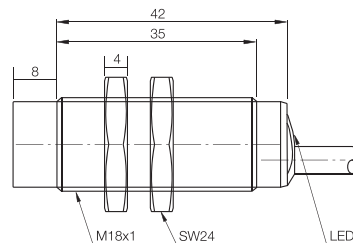

Drawing M18_32

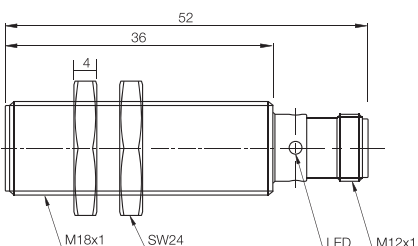

Drawing M18_42

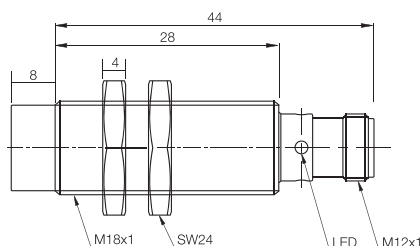

Approvals
Certificates



Metal Barrel-M18

General Data

- Metal housing
- Threaded barrel M18x1
- DC 4-wire
- Function display LED
- Degree of protection IP67
- Standard size
- Flush/non flush mounting



Technical Data

Type	Rated operating distance S_n	Mounting	Output function	Output type	Voltage-range U_g	Rated current	Switching frequency	Ambient temperature	Connection	Mechanical Drawing
<i>Fi5-M18-BP6L</i>	5 mm	flush	NO+NC	PNP	10...30VDC	≤200mA	1000Hz	-25...70°C	2m cable	M18_12
<i>Fi5-M18-BN6L</i>	5 mm	flush	NO+NC	NPN	10...30VDC	≤200mA	1000Hz	-25...70°C	2m cable	M18_12
<i>Ni8-M18-BP6L</i>	8 mm	non flush	NO+NC	PNP	10...30VDC	≤200mA	800Hz	-25...70°C	2m cable	M18_22
<i>Ni8-M18-BN6L</i>	8 mm	non flush	NO+NC	NPN	10...30VDC	≤200mA	800Hz	-25...70°C	2m cable	M18_22
<i>Fi5-M18-BP6L-Q12</i>	5 mm	flush	NO+NC	PNP	10...30VDC	≤200mA	1000Hz	-25...70°C	M12 connector	M18_33
<i>Fi5-M18-BN6L-Q12</i>	5 mm	flush	NO+NC	NPN	10...30VDC	≤200mA	1000Hz	-25...70°C	M12 connector	M18_33
<i>Ni8-M18-BP6L-Q12</i>	8 mm	non flush	NO+NC	PNP	10...30VDC	≤200mA	800Hz	-25...70°C	M12 connector	M18_43
<i>Ni8-M18-BN6L-Q12</i>	8 mm	non flush	NO+NC	NPN	10...30VDC	≤200mA	800Hz	-25...70°C	M12 connector	M18_43

Connection Diagram

Bu = blue; Bn = brown; Bk = black; Wh = white; (1-4) = Connector pin M12

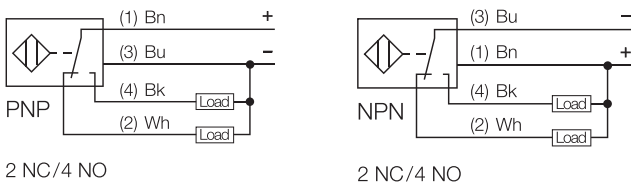

Mechanical Drawing

Drawing M18_12

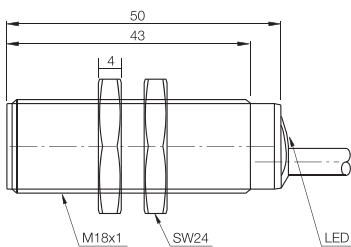

Drawing M18_22

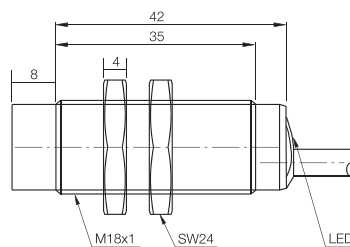

Drawing M18_33

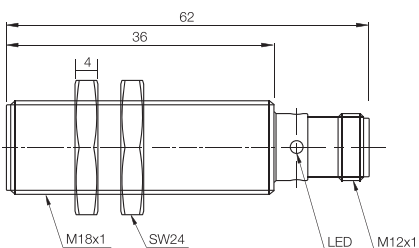

Drawing M18_43

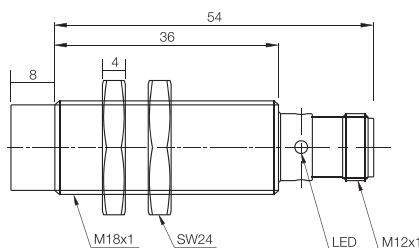

Approvals
Certificates



Metal Barrel-M18 Long Version

General Data

- Metal housing
- Threaded barrel M18x1
- DC 3/4-wire
- Function display LED
- Degree of protection IP67
- Flush/non flush mounting



Technical Data

Type	Rated operating distance S_n	Mounting	Output function	Output type	Voltage-range U_b	Rated current	Switching frequency	Ambient temperature	Connection	Mechanical Drawing
<i>Fi5-M18E-OP6L</i>	5 mm	flush	NO	PNP	10...30VDC	≤200mA	1000Hz	-25...70°C	2m cable	M18_13
<i>Fi5-M18E-ON6L</i>	5 mm	flush	NO	NPN	10...30VDC	≤200mA	1000Hz	-25...70°C	2m cable	M18_13
<i>Fi5-M18E-CP6L</i>	5 mm	flush	NC	PNP	10...30VDC	≤200mA	1000Hz	-25...70°C	2m cable	M18_13
<i>Fi5-M18E-CN6L</i>	5 mm	flush	NC	NPN	10...30VDC	≤200mA	1000Hz	-25...70°C	2m cable	M18_13
<i>Fi5-M18E-BP6L</i>	5 mm	flush	NO+NC	PNP	10...30VDC	≤200mA	1000Hz	-25...70°C	2m cable	M18_13
<i>Fi5-M18E-BN6L</i>	5 mm	flush	NO+NC	NPN	10...30VDC	≤200mA	1000Hz	-25...70°C	2m cable	M18_13
<i>Ni8-M18E-OP6L</i>	8 mm	non flush	NO	PNP	10...30VDC	≤200mA	800Hz	-25...70°C	2m cable	M18_23
<i>Ni8-M18E-ON6L</i>	8 mm	non flush	NO	NPN	10...30VDC	≤200mA	800Hz	-25...70°C	2m cable	M18_23
<i>Ni8-M18E-CP6L</i>	8 mm	non flush	NC	PNP	10...30VDC	≤200mA	800Hz	-25...70°C	2m cable	M18_23
<i>Ni8-M18E-CN6L</i>	8 mm	non flush	NC	NPN	10...30VDC	≤200mA	800Hz	-25...70°C	2m cable	M18_23
<i>Ni8-M18E-BP6L</i>	8 mm	non flush	NO+NC	PNP	10...30VDC	≤200mA	800Hz	-25...70°C	2m cable	M18_23
<i>Ni8-M18E-BN6L</i>	8 mm	non flush	NO+NC	NPN	10...30VDC	≤200mA	800Hz	-25...70°C	2m cable	M18_23

Connection Diagram

Bu = blue; Bn = brown; Bk = black; Wh = white; (1-4) = Connector pin M12

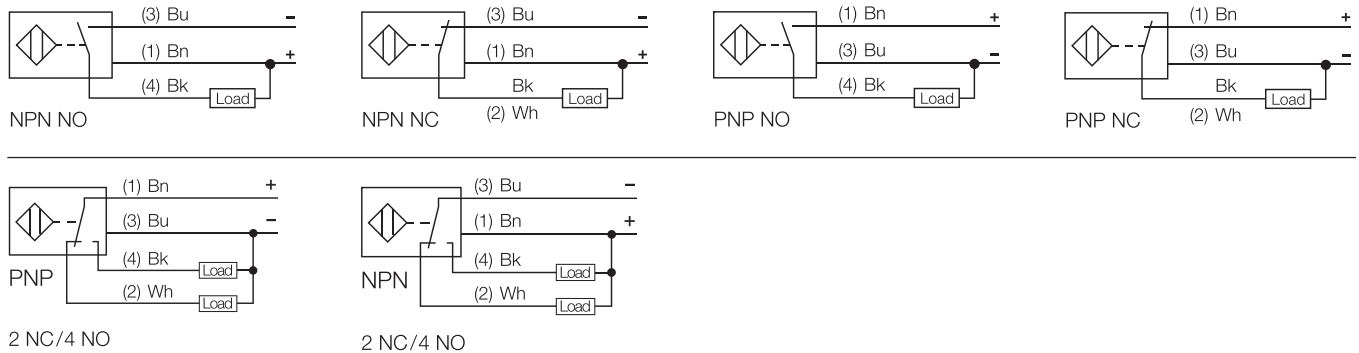

Mechanical Drawing

Drawing M18_13

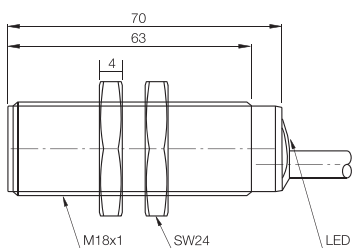

Drawing M18_23

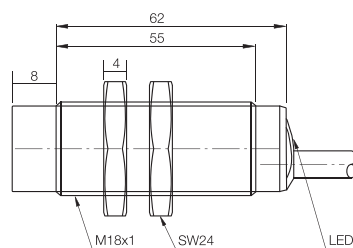

Approvals
Certificates



Metal Barrel-M18 Long Version

General Data

- Metal housing
- Threaded barrel M18x1
- DC 3/4-wire
- Function display LED
- Degree of protection IP67
- Flush/non flush mounting



Technical Data

Type	Rated operating distance S_n	Mounting	Output function	Output type	Voltage-range U_g	Rated current	Switching frequency	Ambient temperature	Connection	Mechanical Drawing
<i>Fi5-M18E-OP6L-Q12</i>	5 mm	flush	NO	PNP	10...30VDC	≤200mA	1000Hz	-25...70°C	M12 connector	M18_34
<i>Fi5-M18E-ON6L-Q12</i>	5 mm	flush	NO	NPN	10...30VDC	≤200mA	1000Hz	-25...70°C	M12 connector	M18_34
<i>Fi5-M18E-CP6L-Q12</i>	5 mm	flush	NC	PNP	10...30VDC	≤200mA	1000Hz	-25...70°C	M12 connector	M18_34
<i>Fi5-M18E-CN6L-Q12</i>	5 mm	flush	NC	NPN	10...30VDC	≤200mA	1000Hz	-25...70°C	M12 connector	M18_34
<i>Fi5-M18E-BP6L-Q12</i>	5 mm	flush	NO+NC	PNP	10...30VDC	≤200mA	1000Hz	-25...70°C	M12 connector	M18_34
<i>Fi5-M18E-BN6L-Q12</i>	5 mm	flush	NO+NC	NPN	10...30VDC	≤200mA	1000Hz	-25...70°C	M12 connector	M18_34
<i>Ni8-M18E-OP6L-Q12</i>	8 mm	non flush	NO	PNP	10...30VDC	≤200mA	800Hz	-25...70°C	M12 connector	M18_44
<i>Ni8-M18E-ON6L-Q12</i>	8 mm	non flush	NO	NPN	10...30VDC	≤200mA	800Hz	-25...70°C	M12 connector	M18_44
<i>Ni8-M18E-CP6L-Q12</i>	8 mm	non flush	NC	PNP	10...30VDC	≤200mA	800Hz	-25...70°C	M12 connector	M18_44
<i>Ni8-M18E-CN6L-Q12</i>	8 mm	non flush	NC	NPN	10...30VDC	≤200mA	800Hz	-25...70°C	M12 connector	M18_44
<i>Ni8-M18E-BP6L-Q12</i>	8 mm	non flush	NO+NC	PNP	10...30VDC	≤200mA	800Hz	-25...70°C	M12 connector	M18_44
<i>Ni8-M18E-BN6L-Q12</i>	8 mm	non flush	NO+NC	NPN	10...30VDC	≤200mA	800Hz	-25...70°C	M12 connector	M18_44

Connection Diagram Bu = blue; Bn = brown; Bk = black; Wh = white; (1-4) = Connector pin M12

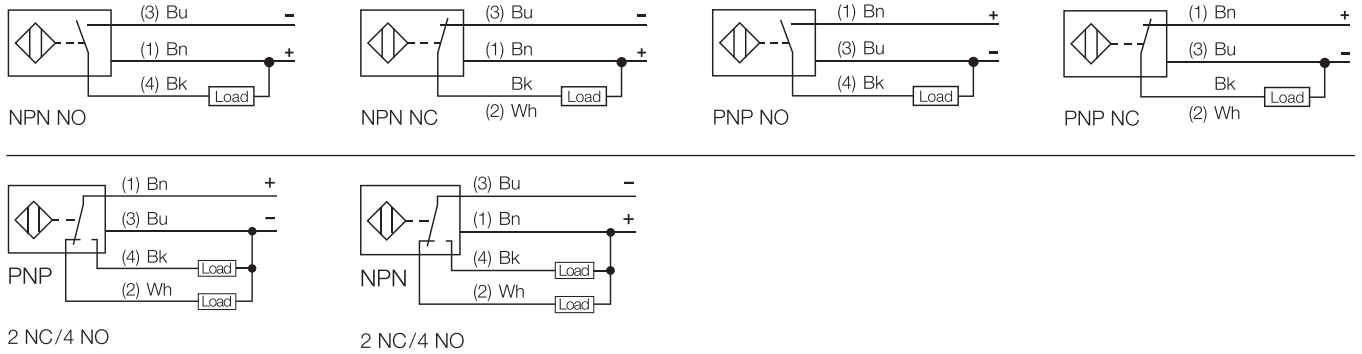

Mechanical Drawing

Drawing M18_34

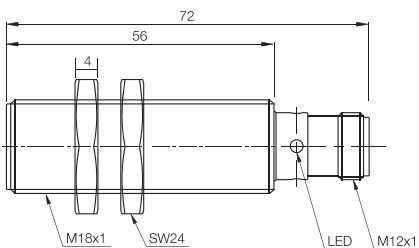

Drawing M18_44

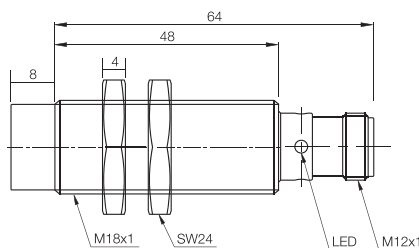

Approvals
Certificates



Metal Barrel-M18

General Data

- Metal housing
- Threaded barrel M18x1
- Extended operating distance
- DC 3-wire
- Function display LED
- Degree of protection IP67
- Standard size



Technical Data

Type	Rated operating distance S_n	Mounting	Output function	Output type	Voltage-range U_b	Rated current	Switching frequency	Ambient temperature	Connection	Mechanical Drawing
<i>Ni10-M18-OP6L</i>	10mm	non flush	NO	PNP	10...30VDC	≤200mA	500Hz	-25...70°C	2m cable	M18_22
<i>Ni10-M18-ON6L</i>	10mm	non flush	NO	NPN	10...30VDC	≤200mA	500Hz	-25...70°C	2m cable	M18_22
<i>Ni10-M18-CP6L</i>	10mm	non flush	NC	PNP	10...30VDC	≤200mA	500Hz	-25...70°C	2m cable	M18_22
<i>Ni10-M18-CN6L</i>	10mm	non flush	NC	NPN	10...30VDC	≤200mA	500Hz	-25...70°C	2m cable	M18_22
<i>Ni10-M18-OP6L-Q12</i>	10mm	non flush	NO	PNP	10...30VDC	≤200mA	300Hz	-25...70°C	M12 connector	M18_42
<i>Ni10-M18-ON6L-Q12</i>	10mm	non flush	NO	NPN	10...30VDC	≤200mA	300Hz	-25...70°C	M12 connector	M18_42
<i>Ni10-M18-CP6L-Q12</i>	10mm	non flush	NC	PNP	10...30VDC	≤200mA	300Hz	-25...70°C	M12 connector	M18_42
<i>Ni10-M18-CN6L-Q12</i>	10mm	non flush	NC	NPN	10...30VDC	≤200mA	300Hz	-25...70°C	M12 connector	M18_42

Connection Diagram

Bu = blue; Bn = brown; Bk = black; Wh = white; (1-4) = Connector pin M12

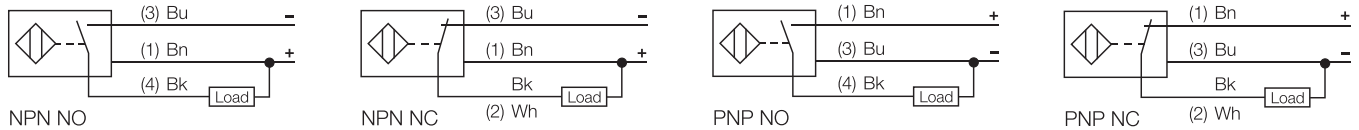

Mechanical Drawing

Drawing M18_22

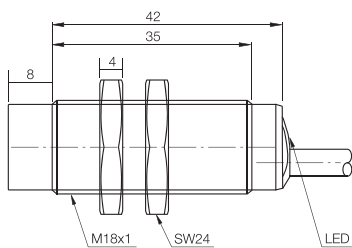

Drawing M18_42

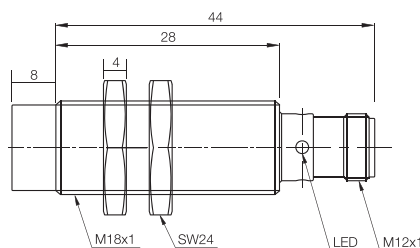

Approvals
Certificates



Metal Barrel-M18

General Data

- Metal housing
- Threaded barrel M18x1
- AC 2-wire
- Function display LED
- Degree of protection IP67
- Standard size
- Flush/non flush mounting
- Wide voltage range



Technical Data

Type	Rated operating distance S_n	Mounting	Output function	Output type	Voltage-range U_b	Rated current	Switching frequency	Ambient temperature	Connection	Mechanical Drawing
<i>Fi5-M18-OSA3L</i>	5 mm	flush	NO	AC	20...250VAC	≤300mA	20Hz	-25...70°C	2m cable	M18_14
<i>Fi5-M18-CSA3L</i>	5 mm	flush	NC	AC	20...250VAC	≤300mA	20Hz	-25...70°C	2m cable	M18_14
<i>Ni8-M18-OSA3L</i>	8 mm	non flush	NO	AC	20...250VAC	≤300mA	20Hz	-25...70°C	2m cable	M18_24
<i>Ni8-M18-CSA3L</i>	8 mm	non flush	NC	AC	20...250VAC	≤300mA	20Hz	-25...70°C	2m cable	M18_24
<i>Fi5-M18-OSA3L-Q12</i>	5 mm	flush	NO	AC	20...250VAC	≤300mA	20Hz	-25...70°C	M12 connector	M18_35
<i>Fi5-M18-CSA3L-Q12</i>	5 mm	flush	NC	AC	20...250VAC	≤300mA	20Hz	-25...70°C	M12 connector	M18_35
<i>Ni8-M18-OSA3L-Q12</i>	8 mm	non flush	NO	AC	20...250VAC	≤300mA	20Hz	-25...70°C	M12 connector	M18_45
<i>Ni8-M18-CSA3L-Q12</i>	8 mm	non flush	NC	AC	20...250VAC	≤300mA	20Hz	-25...70°C	M12 connector	M18_45

Connection Diagram

Bu = blue; Bn = brown; Bk = black; Wh = white; (1-4) = Connector pin M12

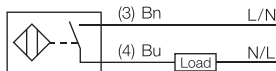

AC-2 wire NO

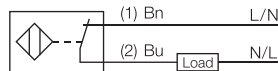

AC-2 wire NC

Mechanical Drawing

Drawing M18_14

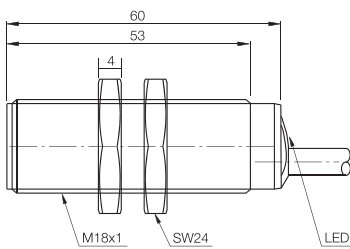

Drawing M18_24

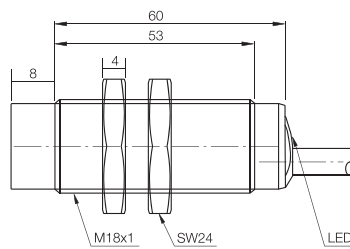

Drawing M18_35

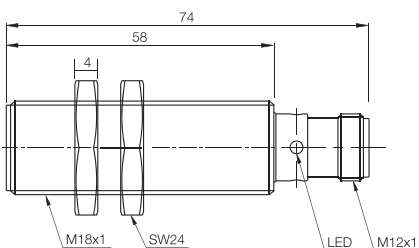

Drawing M18_45

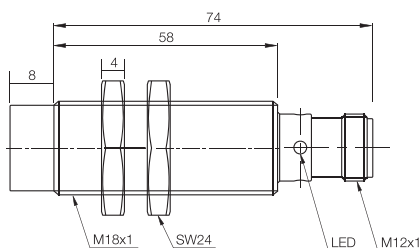

Approvals
Certificates



Metal Barrel-M18

General Data

- Metal housing
- Threaded barrel M18x1
- AC/DC 2-wire
- Function display LED
- Degree of protection IP67
- Standard size
- Flush/non flush mounting
- Wide voltage range



Technical Data

Type	Rated operating distance S_n	Mounting	Output function	Output type	Voltage-range U_b	Rated current	Switching frequency AC // DC	Ambient temperature	Connection	Mechanical Drawing
<i>Fi5-M18-OA41L</i>	5 mm	flush	NO	AC/DC	20...250VAC/DC	≤300mA	15Hz//50Hz	-25...85°C	2m cable	M18_14
<i>Fi5-M18-CA41L</i>	5 mm	flush	NC	AC/DC	20...250VAC/DC	≤300mA	15Hz//50Hz	-25...85°C	2m cable	M18_14
<i>Ni8-M18-OA41L</i>	8 mm	non flush	NO	AC/DC	20...250VAC/DC	≤300mA	15Hz//50Hz	-25...85°C	2m cable	M18_24
<i>Ni8-M18-CA41L</i>	8 mm	non flush	NC	AC/DC	20...250VAC/DC	≤300mA	15Hz//50Hz	-25...85°C	2m cable	M18_24
<i>Fi5-M18-OA41L-Q12</i>	5 mm	flush	NO	AC/DC	20...250VAC/DC	≤300mA	15Hz//50Hz	-25...85°C	M12 connector	M18_35
<i>Fi5-M18-CA41L-Q12</i>	5 mm	flush	NC	AC/DC	20...250VAC/DC	≤300mA	15Hz//50Hz	-25...85°C	M12 connector	M18_35
<i>Ni8-M18-OA41L-Q12</i>	8 mm	non flush	NO	AC/DC	20...250VAC/DC	≤300mA	15Hz//50Hz	-25...85°C	M12 connector	M18_45
<i>Ni8-M18-CA41L-Q12</i>	8 mm	non flush	NC	AC/DC	20...250VAC/DC	≤300mA	15Hz//50Hz	-25...85°C	M12 connector	M18_45

Connection Diagram

Bu = blue; Bn = brown; Bk = black; Wh = white; (1-4) = Connector pin M12

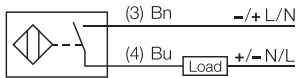

AC/DC-2 wire NO

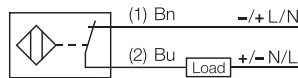

AC/DC-2 wire NC

Mechanical Drawing

Drawing M18_14

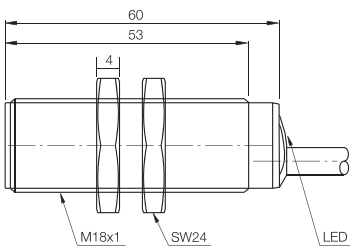

Drawing M18_24

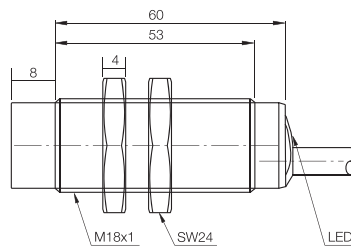

Drawing M18_35

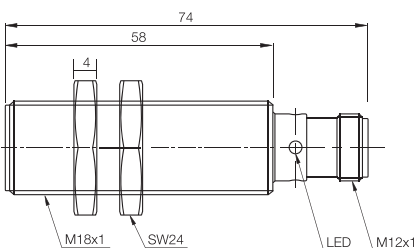

Drawing M18_45

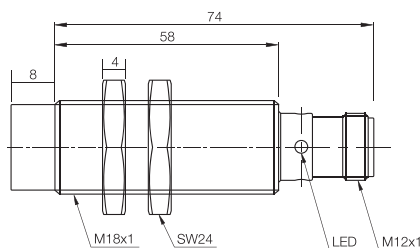

Approvals
Certificates

