

Right handed version

Fix driver bolt  
with locktite 638  
and tighten until  
high shoulder

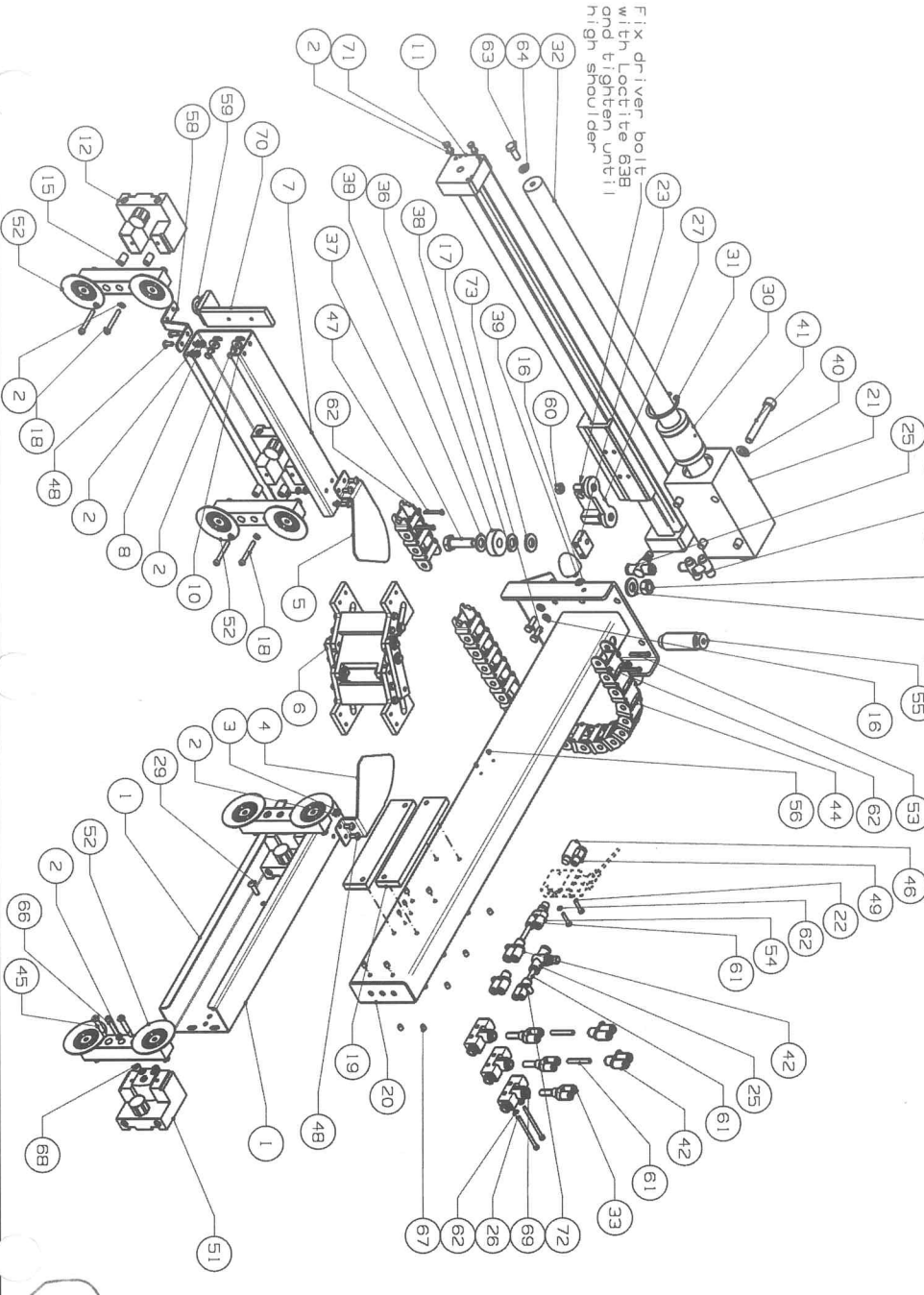

No	Part No	QTY	Descr   Ption
73	195198/A	2	Nord Lock washer M12
72	001343/C	1	Union Y K02U04-06
71	002242/A	4	DIN933 M5x16
70	004014/C	1	Curve guide
69	120652/A	3	Vac generator VN-10HT4-P02V03R03
68	005410/A	2	Spacer
67	002006/A	12	DIN916 M6x8
66	001812/A	2	DIN912 M5x30
64	001562/A	1	DIN127 A8
63	002287/A	1	DIN933 M6x20
62	001559/A	8	DIN127 A4
61	003174/A	4	Push-in sleeve OSH-6
60	001531/A	1	DIN934 M6
59	000505/A	1	Thrust washer PAW 12 P10
58	077237/D	1	Retainer plate
56	001991/A	4	DIN916 M4x6
55	052465/A	1	Y-connector UDM-3/8
54	002189/B	1	DIN912 M4x30
53	001801/A	2	DIN912 M4x30
52	060924/A	4	Assy bracket suction cups
51	060936/C	2	Assy sliding block suction cups
50	001529/A	1	DIN934 M6
49	000657/C	1	Straight coupling K02H08-015
48	002183/A	6	ISO7360 M5x12
47	002051/A	2	DIN84 M4x30
46	001474/A	1	Silencer U-1/8
45	006860/A	4	ISO7379 IM516x25
44	006859/A	25	Coil chain Kollibri 05 35/70
43	061451/A	1	Phantom see pneumatic list
42	001339/C	4	Union Y K02U06-00
41	001859/A	4	DIN912 M10x70
40	001563/A	4	DIN127 A10
39	000718/A	2	Buffer PK/D 30x30 M6x12
38	001574/A	2	DIN125 A13
37	002348/A	1	DIN933 M12x40
36	000281/A	1	Ball bearing 6301-LLU
35	001533/A	1	DIN934 M12
33	061454/A	3	Y quick connector 05Y-BH-6
32	061560/A	1	Shaft hardened and ground
31	001638/A	2	DIN472 47x1.75
30	000593/B	2	Linear bearing K530-PP
29	002185/A	4	ISO7360 M6x20
27	061456/A	1	Driver FK-25
26	061455/A	2	Flow control valve AS2001F-06
25	043705/B	2	Flow valve AS2201F-01-06-SD
24	000939/B	2	Bracket driver
23	061559/A	1	DIN933 M4x20
22	002223/A	2	DIN933 M4x20
21	000926/A	1	Dual bearing block 30
20	004150/G	1	Arm suction frame
19	004151/A	2	Filling strip
18	001814/A	4	DIN912 M5x40
17	002267/A	2	DIN933 M6x20
16	001561/A	3	DIN127 A6
15	001369/A	4	Spacer
13	061452/A	1	Phantom see electrical list
12	001348/A	2	Assy sliding block suction cups
11	060923/A	1	Cylinder DGC-25-550-G-PPV-A
10	002659/A	2	DIN 7349 A5-3
8	001528/A	6	DIN934 M5
7	004023/B	1	Suction frame B
6	004115/A	1	Assy hinge
5	003918/B	1	Hinge cover low
4	003919/B	1	Hinge cover high
3	002240/A	10	DIN933 M5x12
2	001560/A	26	DIN127 A5
1	004108/B	1	Suction frame A

Assy suction frame

ROUNDSNESS ACCORDING TO DIN 3218 GOVERNOR TOLERANCES ACCORDING TO DIN EN ISO 2768

DRAWN BY: J.Lumbers DATE: 17-SEP-2012

SCALE: --- REVISION: 1

DRAWING NUMBER 061306



REV	DATE	BY	CHKD	DESCRIPTION
1	17-09-2012	J.Lumbers		Initial release
2	17-09-2012	J.Lumbers		Change of drawing number
3	17-09-2012	J.Lumbers		Change of drawing number
4	17-09-2012	J.Lumbers		Change of drawing number
5	17-09-2012	J.Lumbers		Change of drawing number
6	17-09-2012	J.Lumbers		Change of drawing number
7	17-09-2012	J.Lumbers		Change of drawing number
8	17-09-2012	J.Lumbers		Change of drawing number
9	17-09-2012	J.Lumbers		Change of drawing number
10	17-09-2012	J.Lumbers		Change of drawing number
11	17-09-2012	J.Lumbers		Change of drawing number
12	17-09-2012	J.Lumbers		Change of drawing number
13	17-09-2012	J.Lumbers		Change of drawing number
14	17-09-2012	J.Lumbers		Change of drawing number
15	17-09-2012	J.Lumbers		Change of drawing number
16	17-09-2012	J.Lumbers		Change of drawing number
17	17-09-2012	J.Lumbers		Change of drawing number
18	17-09-2012	J.Lumbers		Change of drawing number
19	17-09-2012	J.Lumbers		Change of drawing number
20	17-09-2012	J.Lumbers		Change of drawing number
21	17-09-2012	J.Lumbers		Change of drawing number
22	17-09-2012	J.Lumbers		Change of drawing number
23	17-09-2012	J.Lumbers		Change of drawing number
24	17-09-2012	J.Lumbers		Change of drawing number
25	17-09-2012	J.Lumbers		Change of drawing number
26	17-09-2012	J.Lumbers		Change of drawing number
27	17-09-2012	J.Lumbers		Change of drawing number
28	17-09-2012	J.Lumbers		Change of drawing number
29	17-09-2012	J.Lumbers		Change of drawing number
30	17-09-2012	J.Lumbers		Change of drawing number
31	17-09-2012	J.Lumbers		Change of drawing number
32	17-09-2012	J.Lumbers		Change of drawing number
33	17-09-2012	J.Lumbers		Change of drawing number
34	17-09-2012	J.Lumbers		Change of drawing number
35	17-09-2012	J.Lumbers		Change of drawing number
36	17-09-2012	J.Lumbers		Change of drawing number
37	17-09-2012	J.Lumbers		Change of drawing number
38	17-09-2012	J.Lumbers		Change of drawing number
39	17-09-2012	J.Lumbers		Change of drawing number
40	17-09-2012	J.Lumbers		Change of drawing number
41	17-09-2012	J.Lumbers		Change of drawing number
42	17-09-2012	J.Lumbers		Change of drawing number
43	17-09-2012	J.Lumbers		Change of drawing number
44	17-09-2012	J.Lumbers		Change of drawing number
45	17-09-2012	J.Lumbers		Change of drawing number
46	17-09-2012	J.Lumbers		Change of drawing number
47	17-09-2012	J.Lumbers		Change of drawing number
48	17-09-2012	J.Lumbers		Change of drawing number
49	17-09-2012	J.Lumbers		Change of drawing number
50	17-09-2012	J.Lumbers		Change of drawing number
51	17-09-2012	J.Lumbers		Change of drawing number
52	17-09-2012	J.Lumbers		Change of drawing number
53	17-09-2012	J.Lumbers		Change of drawing number
54	17-09-2012	J.Lumbers		Change of drawing number
55	17-09-2012	J.Lumbers		Change of drawing number
56	17-09-2012	J.Lumbers		Change of drawing number
57	17-09-2012	J.Lumbers		Change of drawing number
58	17-09-2012	J.Lumbers		Change of drawing number
59	17-09-2012	J.Lumbers		Change of drawing number
60	17-09-2012	J.Lumbers		Change of drawing number
61	17-09-2012	J.Lumbers		Change of drawing number
62	17-09-2012	J.Lumbers		Change of drawing number
63	17-09-2012	J.Lumbers		Change of drawing number
64	17-09-2012	J.Lumbers		Change of drawing number
65	17-09-2012	J.Lumbers		Change of drawing number
66	17-09-2012	J.Lumbers		Change of drawing number
67	17-09-2012	J.Lumbers		Change of drawing number
68	17-09-2012	J.Lumbers		Change of drawing number
69	17-09-2012	J.Lumbers		Change of drawing number
70	17-09-2012	J.Lumbers		Change of drawing number
71	17-09-2012	J.Lumbers		Change of drawing number
72	17-09-2012	J.Lumbers		Change of drawing number
73	17-09-2012	J.Lumbers		Change of drawing number